

Presented by:
Jason Dryburgh PREC*

Keller Williams Elite Realty

https://MRKTrealtors.com
jason@mrktrealtors.com



Active
R2675931
Board: V
House/Single Family

23658 113A AVENUE
Maple Ridge
Cottonwood MR
V2W 0C7

Residential Detached
\$1,618,000 (LP)
(SP) **M**



Sold Date:
Meas. Type: **Feet**
Frontage(feet): **0.00**
Frontage(metres):
Depth / Size:
Lot Area (sq.ft.): **5,084.00**
Lot Area (acres): **0.12**
Flood Plain:
View: **Yes: GOLDEN EARS MOUNTAIN**
Complex/Subdiv:
Services Connected: **Electricity, Natural Gas, Sanitary Sewer, Storm Sewer, Water**

If new, GST/HST inc?:
Bedrooms: **6**
Bathrooms: **3**
Full Baths: **3**
Half Baths: **0**
Rear Yard Exp: **South**
P.I.D.: **026-942-216**

Original Price: **\$1,618,000**
Approx. Year Built: **2007**
Age: **15**
Zoning: **RES**
Gross Taxes: **\$5,602.44**
For Tax Year: **2021**
Tax Inc. Utilities?: **No**
Tour:

Sewer Type: **City/Municipal** Water Supply: **City/Municipal**

Style of Home: **2 Storey, Basement Entry**
Construction: **Frame - Wood**
Exterior: **Glass, Vinyl, Wood**
Foundation: **Concrete Perimeter**

Renovations:
of Fireplaces: **2** R.I. Fireplaces:
Fireplace Fuel: **Natural Gas**
Fuel/Heating: **Forced Air, Heat Pump**
Outdoor Area: **Balcny(s) Patio(s) Dck(s), Fenced Yard**
Type of Roof: **Asphalt**

Reno. Year:
Rain Screen:
Metered Water:
R.I. Plumbing:

Total Parking: **6** Covered Parking: **2** Parking Access: **Front, Lane**
Parking: **Add. Parking Avail., Garage, Double, RV Parking Avail.**
Driveway Finish:
Dist. to Public Transit: **NEAR** Dist. to School Bus: **WALK**
Title to Land: **Freehold NonStrata** Land Lease Expiry Year:
Property Disc.: **Yes**
Fixtures Leased: **No**
Fixtures Rmvd: **Yes :MOPAR CABINETS IN GARAGE&BED BELOW, STICKERED ITEMS IN BSMT**
Floor Finish: **Laminate, Tile, Carpet**

Legal: **LOT 11, PLAN BCP27984, SECTION 16, TOWNSHIP 12, NEW WESTMINSTER LAND DISTRICT**

Amenities:

Site Influences: **Central Location, Lane Access, Private Yard, Recreation Nearby**
Features: **ClthWsh/Dryr/Frdg/Stve/DW, Hot Tub Spa/Swirlpool, Storage Shed**

Finished Floor (Main):	1,747	Floor	Type	Dimensions	Floor	Type	Dimensions	Bathrooms
Finished Floor (Above):	0	Main	Dining Room	14'4 x 8'0	Below	Bedroom	9'11 x 14'3	Floor #Pcs
Finished Floor (AbvMain2):	0	Main	Living Room	13'3 x 14'0	Below	Walk-In Closet	5'6 x 5'0	Main 4
Finished Floor (Below):	1,229	Main	Family Room	10'8 x 17'9	Below	Bedroom	9'11 x 10'11	Main 4
Finished Floor (Basement):	0	Main	Eating Area	12'0 x 7'8	Below	Walk-In Closet	4'9 x 3'0	Below 4
Finished Floor (Total):	2,976sq. ft.	Main	Kitchen	11'8 x 11'8	Below	Bedroom	10'0 x 10'9	
Unfinished Floor:	0	Main	Master Bedroom	15'4 x 14'6	Below	Walk-In Closet	4'9 x 3'0	
Grand Total:	2,976sq. ft.	Main	Walk-In Closet	10'1 x 4'11			x	
Flr Area (Det'd 2nd Res):	sq. ft.	Main	Bedroom	9'8 x 10'1			x	
Suite: Unauthorized Suite		Main	Bedroom	15'7 x 9'11			x	
Basement: Full, Fully Finished, Separate Entry		Below	Foyer	10'0 x 14'2			x	
Crawl/Bsmt. Height: # of Levels: 2		Below	Dining Room	7'10 x 9'4			x	
# of Kitchens: 2 # of Rooms: 19		Below	Living Room	17'11 x 9'7			x	
		Below	Kitchen	10'2 x 9'4			x	

Manuf Type: Registered in MHR?: PAD Rental:
MHR#: CSA/BCE: Maint. Fee:
ByLaw Restrictions:

Listing Broker(s): **Keller Williams Elite Realty**

A COMPLETE PACKAGE. Highlights of an IMMACULATE 6 bed/3 bath home in desirable Cottonwood! SPACE. Sprawling layout feels much larger! Modern kitchen, large patio, 3 spacious beds up inc GOLDEN EARS views off Master+ensuite. 4th Bed for above off foyer! Spacious sunny South exp yard for green thumb or unwind in private gazebo+hot tub! Heat pump! CARE. Unbelievable pride of ownership in every inch. Well loved family home sure to impress.. SUITE. Bright walkout 2bed suite perfect for inlaws/income. Designer kitchen w/premium app, sep patio w/gas BBQ.. TOYS. Rare, expansive LEGAL RV PAD off quiet laneway via 20ft wide fence gate opening+SANI DUMP setup! Bonus 25ft deep garage=extra storage! LOCATION. Quiet+convenient setting close to schools+transit+easy commuter access to bypass via Kanaka!

RED Full Public The above information is provided by members of the BC Northern Real Estate Board, Chilliwack & District Real Estate Board, Fraser Valley Real Estate Board or Real Estate Board of Greater Vancouver Board ("the Boards") and is from sources believed reliable but should not be relied upon without verification. The Boards assume no responsibility for its accuracy. PREC* indicates 'Personal Real Estate Corporation'. 04/12/2022 11:24 AM



23658 113A AVE | MAPLE RIDGE

604 465 1850 team@MRKTrealtors.com MRKTrealtors.com



MRKT.
REAL ESTATE GROUP

JASON DRYBURGH
PERSONAL REAL ESTATE CORPORATION

604-839-3004 jason@MRKTrealtors.com

**OWN
YOUR
MARKET**

23658 113A Avenue,
Maple Ridge, B.C.

Main Floor:	1,747 sq.ft.
Lower Floor:	1,229 sq.ft.
Total:	2,976 sq.ft.

Auxiliary Area

Garage:	471 sq.ft.
Patio:	280 sq.ft.
Deck:	156 sq.ft.
Balcony:	167 sq.ft.

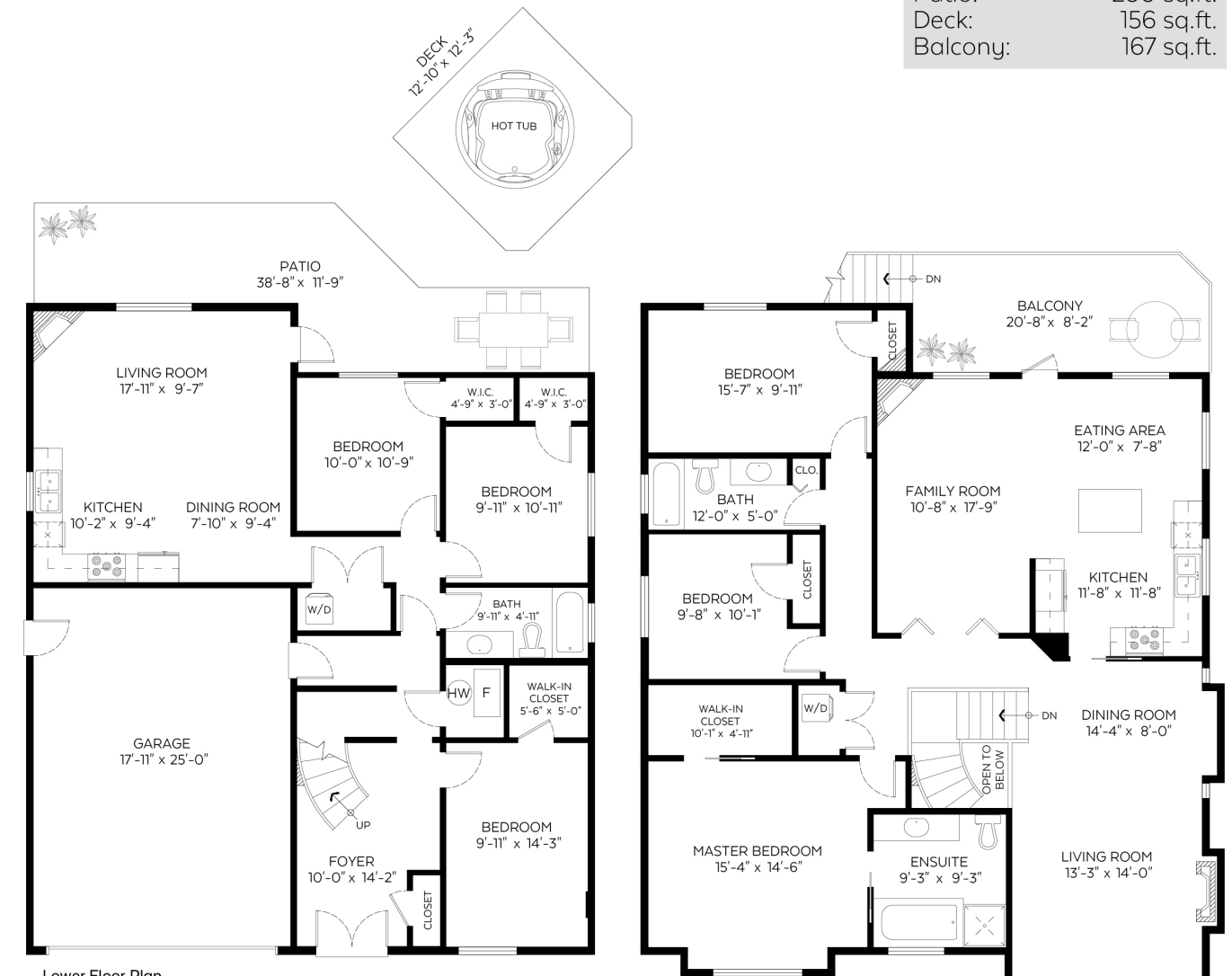

Lower Floor Plan
Floor Area: 1,229 sq.ft.
Ceiling Height: 8 ft.

Main Floor Plan
Floor Area: 1,747 sq.ft.
Ceiling Height: 8 ft.